



COMPLETE 3-PIECE KIT

LIL' KICKER

D1316 Drum Set Owner's Manual



**3-Piece Lil' Kicker Drum Set
(D1316)**

Thank you for purchasing this Lil' Kicker set from Sound Percussion Labs' outstanding line of drums, percussion and hardware.

These instructions should be used as only a general guide. Make adjustments for your comfort and playing style. Experimentation can lead to unique and great experiences in your playing and your music. So experiment with your setup and enjoy!

Also, be sure to visit www.soundpercussionlabs.com for more information on Sound Percussion Labs products and support.

Table of Contents

D1316 Components	3
Bass Drum Head Assembly	4
Bass Drum Leg Assembly	4
Attaching Bass Drum Pedal	5
Mounted Tom Assembly - to the Bass Drum	5
Snare Drum Stand Assembly	6
Hi-Hat Cymbal Stand Assembly	6
Cymbal Arm Assembly	7
Drum Throne Assembly	7
Top View Of Drum Placement	7
Customer Support	8
Warranty	8

PLEASE READ BEFORE ASSEMBLY

- Adult assembly required.
- Please keep printed instructions for future reference.

- **Snare Stand:**

For best playability, position top adjustment angle of snare stand so snare drum playing surface sits flat.

Increasing angle of adjustment can cause snare drum and stand to fall over and may cause injury.

- **Drum Seat:**

Do not use drum seat for other uses than its intended purpose as a seat. Do not stand on throne.

- **WARNING:**

Choking hazard due to small parts.

Not for children under 3 years old.



COMPLETE 3-PIECE KIT

LIL' KICKER

D1316 DRUM SET OWNER'S MANUAL

Thank you for purchasing this Sound Percussion Labs™ drum set. Please take a few moments to familiarize yourself with this set-up guide so you can assemble your new drums quickly and easily. For additional information as well as troubleshooting advice and parts requests, please visit www.soundpercussionlabs.com

SET INCLUDES:

- A** 16" x 12" Bass Drum Shell
- B** 8" x 5" Mounted Tom Drum
- C** 10" x 4" Snare Drum
- D** 16" Clear Batter Side Bass Drum Head
- E** 16" Black w/logo, Resonant Side, Bass Drum Head
Note: Snare Drum and Tom heads are already installed on snare and tom.
- F** Two Bass Drum Legs
- G** Tom Arm
- H** Snare Drum Stand
- I** Hi-Hat Stand
- J** Cymbal Arm
- K** Crash/Ride Cymbal
- L** Pair of Hi-Hat Cymbals
- M** Two Bass Drum Hoops
- N** Bass Drum Pedal
- O** Bass Drum Beater
- P** Pair of Drumsticks
- Q** Drum Throne
- R** 12 Washers
- S** 12 Long Tension Rods
- T** Drum Key
- U** Thumbscrew for Snare Stand
- V** Bolt and Wingnut Set for Hi-Hat Stand
- W** 12 Bass Drum "Claws"

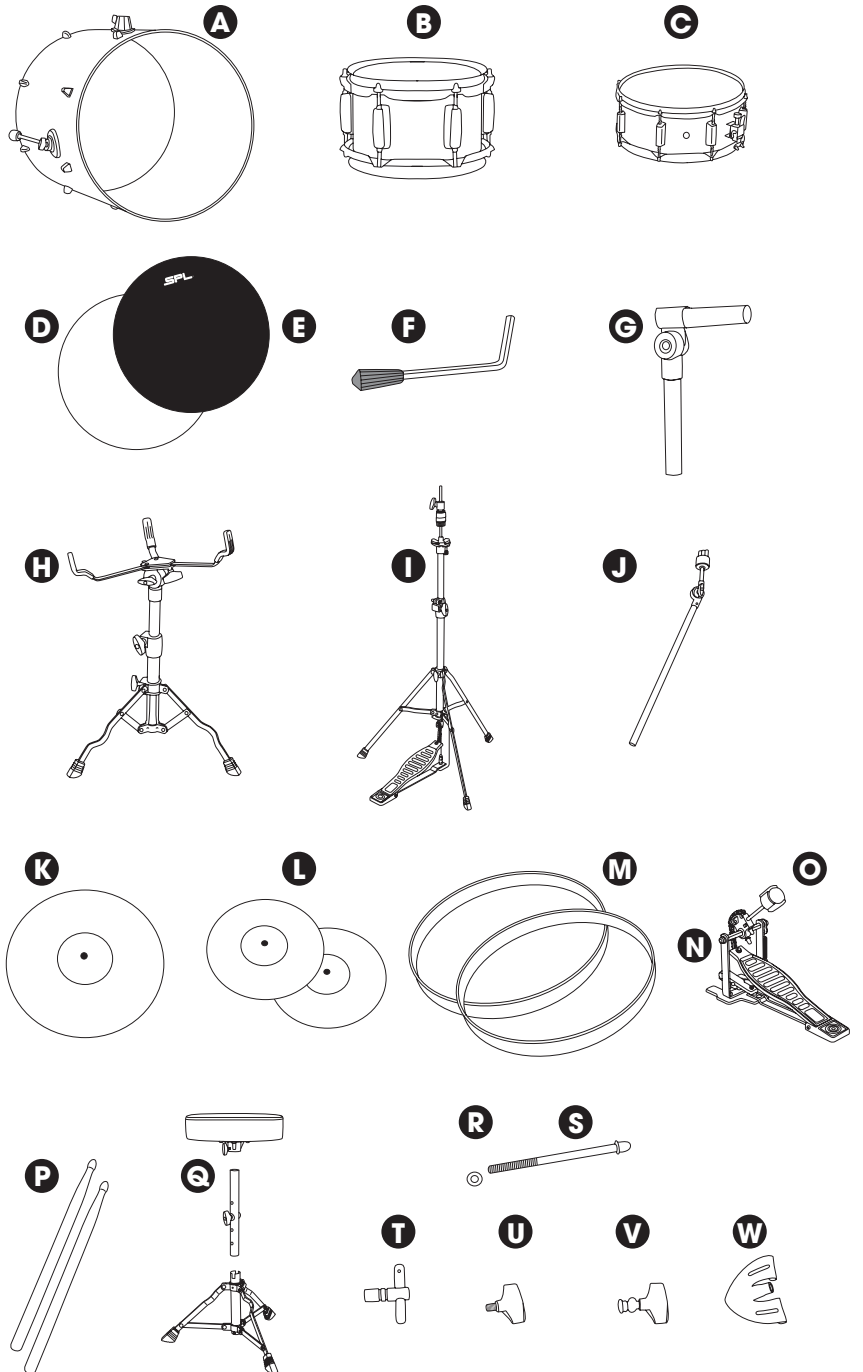

Adult assembly required



WARNING: Choking hazard - small parts. Not for children under 3 years old.



Bass Drum Head Assembly

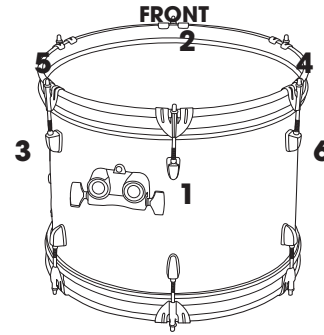
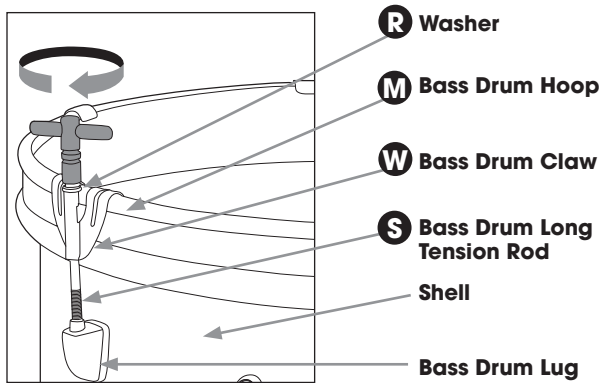

BACK - Drummer's Side

1. Place the bass drum logo head **(E)** over front of the bass drum shell **(A)** and center logo.
2. Place one of the bass drum hoops **(M)** onto drum head.
3. Insert long tension rod **(S)** / washer **(R)** / bass drum claw **(W)** hook assembly into bass drum lug. Make sure the claw hook is secure on the bass drum hoop. Tighten with your fingers.
4. Repeat this for all the lugs on one side of the drum.
5. After all tension rods on one side are finger tight, use the drum key **(T)** to tighten the #1 tension rod 3 turns. Follow these steps for tension rods #2 through #6 in a criss-cross pattern as shown. Repeat this pattern, tightening each rod one half turn until the drum head is taut and wrinkle free.
6. Repeat for the clear batter head **(D)** on the opposite side of the drum.

Bass Drum Leg Assembly (Spurs)

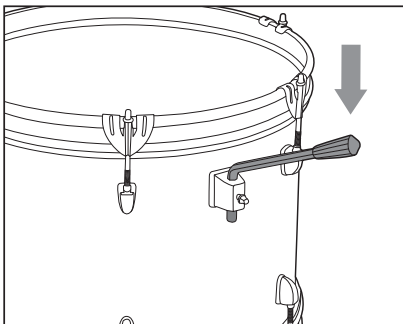

1. Insert both legs **(F)** through the assemblies at bottom sides of the bass drum and tighten screw with drum key.
2. Adjust the angle to ensure bass drum sits evenly on the floor when positioned.

Attaching Bass Drum Pedal

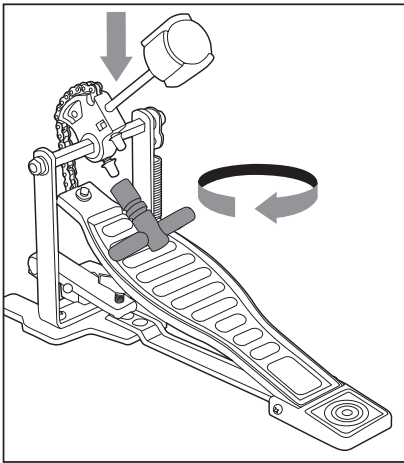

1. Insert the bass drum beater (O) into the bass drum pedal (N) and tighten with the drum key.
2. Attach bass pedal to the bass drum hoop using the toe clamp.

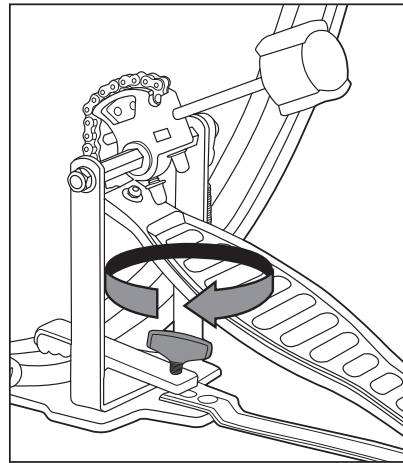

3. Tighten the wingnut on the toe clamp until secure.
4. Position the bass drum beater to strike the center of the bass drum.

Mounting the Toms to the Bass Drum

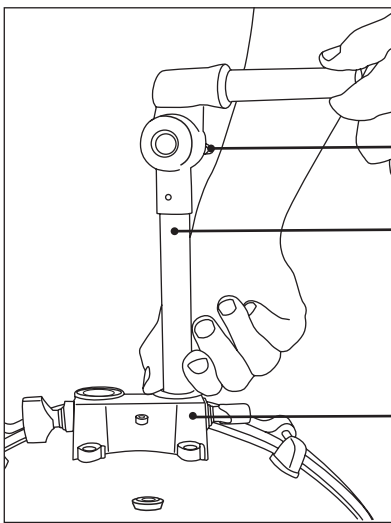

- Wing Nut
- Tom Arm
- Bass Tom Mount

1. Insert long section of the tom arm a few inches into the bass tom mount.
2. Tighten the wing nut on the bass tom mount.
3. Loosen the wing nut on the tom arm and angle the top part of the tom arm to just below horizontal and retighten the wing nut.
4. Place the mounted tom onto the tom arm and tighten the wing nut on the tom mount.

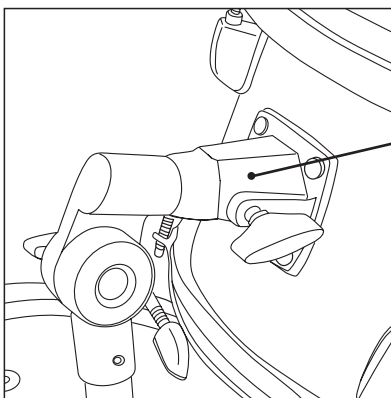

- Tom Mount

Snare Drum Stand Assembly

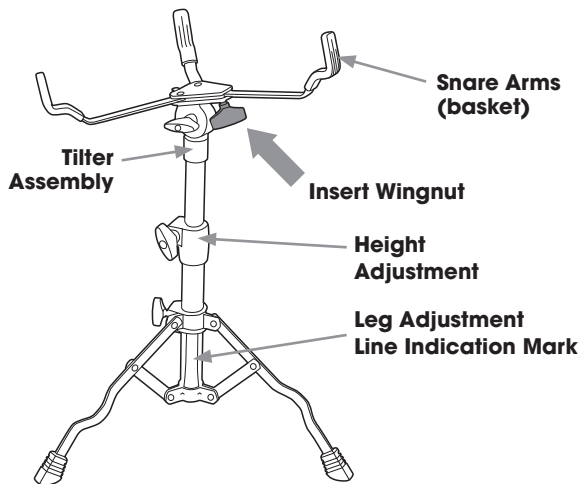

1. Extend legs of snare drum stand **(H)** into open position. Adjust down to top of line indication mark at leg base. This will ensure maximum stability for the snare drum stand.
2. Insert wingnut **(U)** into middle snare arm.
3. Adjust the basket to the angle shown with the tilter assembly.
4. Place snare drum **(C)** in snare basket. For best playability, position top adjustment angle of snare stand so snare drum playing surface sits flat. Increasing angle of adjustment can cause snare drum and stand to fall over and may cause injury. Position the arms to fit snug to the drum.

Hi-Hat Cymbal Stand Assembly

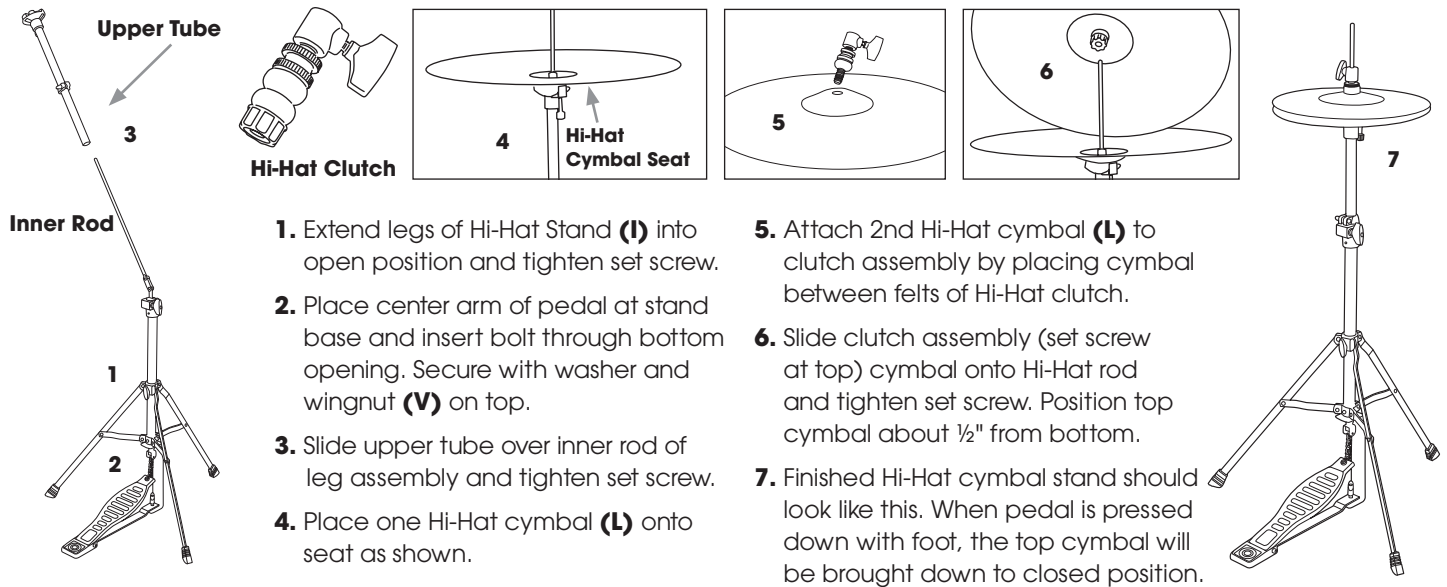

1. Extend legs of Hi-Hat Stand **(I)** into open position and tighten set screw.
2. Place center arm of pedal at stand base and insert bolt through bottom opening. Secure with washer and wingnut **(V)** on top.
3. Slide upper tube over inner rod of leg assembly and tighten set screw.
4. Place one Hi-Hat cymbal **(L)** onto seat as shown.
5. Attach 2nd Hi-Hat cymbal **(L)** to clutch assembly by placing cymbal between felts of Hi-Hat clutch.
6. Slide clutch assembly (set screw at top) cymbal onto Hi-Hat rod and tighten set screw. Position top cymbal about 1/2" from bottom.
7. Finished Hi-Hat cymbal stand should look like this. When pedal is pressed down with foot, the top cymbal will be brought down to closed position.

Cymbal Arm Assembly

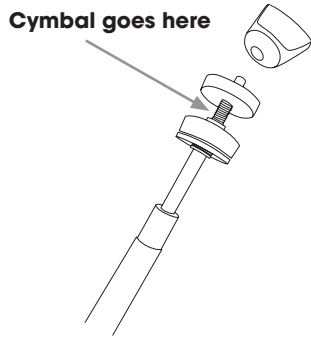

1. Slide cymbal arm **(J)** into mount of bass drum and set desired height using wingnut.
2. Place cymbal **(K)** between felt pads. Tighten wingnut above cymbal only enough to hold cymbal and felts, but loose enough to let cymbal move freely when struck.
3. Set desired cymbal angle using filter adjustment.

Drum Throne Assembly

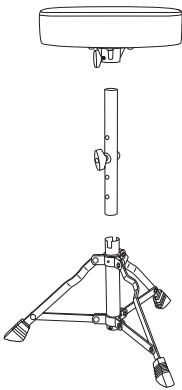

1. Fold out legs at base of Drum Throne **(Q)**.
2. Place center tube into base and tighten height adjustment wingnut. It is recommended to place wingnut as shown for comfortable playing style.
3. Place seat top and tighten wingnut.

Do not use drum seat for other uses than its intended purpose as a seat. Do not stand on throne.

Top View of Drum Placement

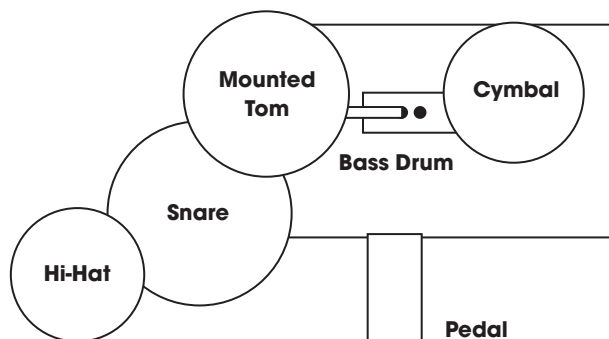



CUSTOMER & WARRANTY SUPPORT



HAVE QUESTIONS?

MISSING
— OR —
DAMAGED
PARTS?



— HAVE —
ASSEMBLY
QUESTIONS?

OR VISIT OUR WEBSITE AT: [HTTP://SOUNDPERCUSSIONLABS.COM/](http://soundpercussionlabs.com/)

**PLEASE DO NOT CALL THE RETAILER WHERE YOU
PURCHASED THIS PRODUCT FOR SUPPORT OR PARTS!**

Warranty

One (1) Year Limited Warranty

Subject to the limitations set forth below, Sound Percussion Labs™ hereby represents and warrants that the components of this product shall be free from defects in workmanship and materials, including implied warranties of merchantability or fitness for a particular purpose, subject to normal use and service, for one (1) years to the original owner from the date of purchase.

Limits of Liability

Retailer and manufacturer shall not be liable for damages based upon inconvenience, loss of use of product, loss of time, interrupted operation or commercial loss or any other incidental or consequential damages including but not limited to lost profits, downtime, goodwill, damage to or replacement of equipment and property, and any costs of recovering, reprogramming, or reproducing any program or data stored in equipment that is used with Sound Percussion Labs™ products. This guarantee gives you specific legal rights. You may have other legal rights which vary from state to state. Some states do not allow limitations on how long an implied warranty lasts, so the above limitation may not apply to you.

Sound Percussion Labs
P.O. Box 5111
Thousand Oaks, CA 91359-5111

All trademarks and registered trademarks mentioned herein are recognized as the property of their respective holders.

1604-16133285