



# unity kit

D4420 & D4522 Drum Set Owner's Manual

## 4-Piece Shell Pack Plus Drum Kit (D4420)



## 5-Piece Complete Drum Kit (D4522)

[SoundPercussionLabs.com](http://SoundPercussionLabs.com)

Thank you for purchasing this kit from Sound Percussion Labs' outstanding line of drums, percussion and hardware. They offer unlimited enjoyment and will create a solid foundation for your playing.

This owner's manual includes two drum kit models. Be sure to locate the model number of your kit to follow the correct assembly instructions.

These instructions should be used as only a general guide. Make adjustments for your comfort and playing style. Experimentation can lead to unique and great experiences in your playing and your music. So experiment with your setup and enjoy!

Also, be sure to visit [www.soundpercussionlabs.com](http://www.soundpercussionlabs.com) for more information on Sound Percussion Labs products and support.

### Table of Contents

D4420 Parts Index.....	<b>2</b>
D4522 Parts Index.....	<b>3</b>
Bass Drum Head Assembly.....	<b>4</b>
Bass Drum Leg Assembly.....	<b>4</b>
Floor Tom Head Assembly.....	<b>4</b>
Floor Tom Leg Assembly.....	<b>5</b>
Mounting the Toms to the Bass Drum.....	<b>5</b>
Cymbal Stand Assembly.....	<b>6</b>
Snare Drum Stand Assembly.....	<b>6</b>
Attaching the Bass Drum Pedal.....	<b>6</b>
Hi-Hat Cymbal Stand Assembly.....	<b>7</b>
Assembling the Drum Throne.....	<b>8</b>
Top View Drum Placement.....	<b>8-9</b>

# 4-Piece unity kit Parts Index

## D4420

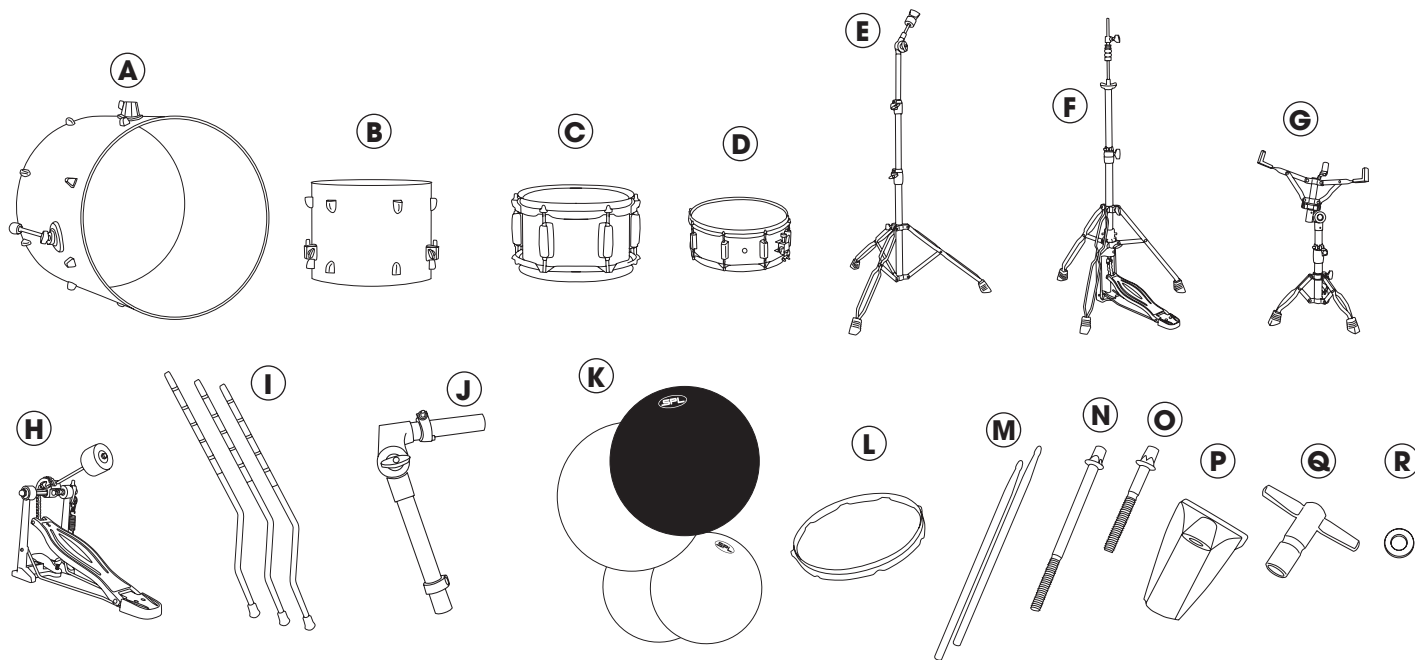

### SET INCLUDES:

#### Drums:

- A** 20"x16" Bass Drum
- B** 14"x12" Floor Tom Drum
- C** 12"x 8" Mounted Tom Drum
- D** 13"x 5" Snare Drum
- E** Cymbal Stand
- F** Hi-Hat Stand
- G** Snare Drum Stand
- H** Bass Drum Pedal
- I** Three Floor Tom Legs
- J** Tom Arm

#### **K** Drum Heads:

- 20" Clear Batter Side Bass Drum Head
- 20" Black w/logo, Resonant Side, Bass Drum Head
- 14" Batter Side Floor Tom Head
- 14" Resonant Side Floor Tom Head
- 12" Batter Side Mounted Tom Drum Head
- 12" Resonant Side Mounted Tom Drum Head

**NOTE:** Snare drum heads are already installed on snare

#### **L** Hoops:

- Two Floor Tom Hoops
- Two Mounted Tom Hoops
- Two Bass Drum Hoops

#### **M** Pair of Drumsticks

#### **Bag Packaged Parts:**

- N** 16 Long Tension Rods for Bass Drum
- O** 24 Short Tension Rods for Floor/Mounted Tom
- P** 16 Bass Drum "Claws"
- Q** Drum Key
- R** Washers



# 5-Piece Complete unity kit Parts Index

## D4522

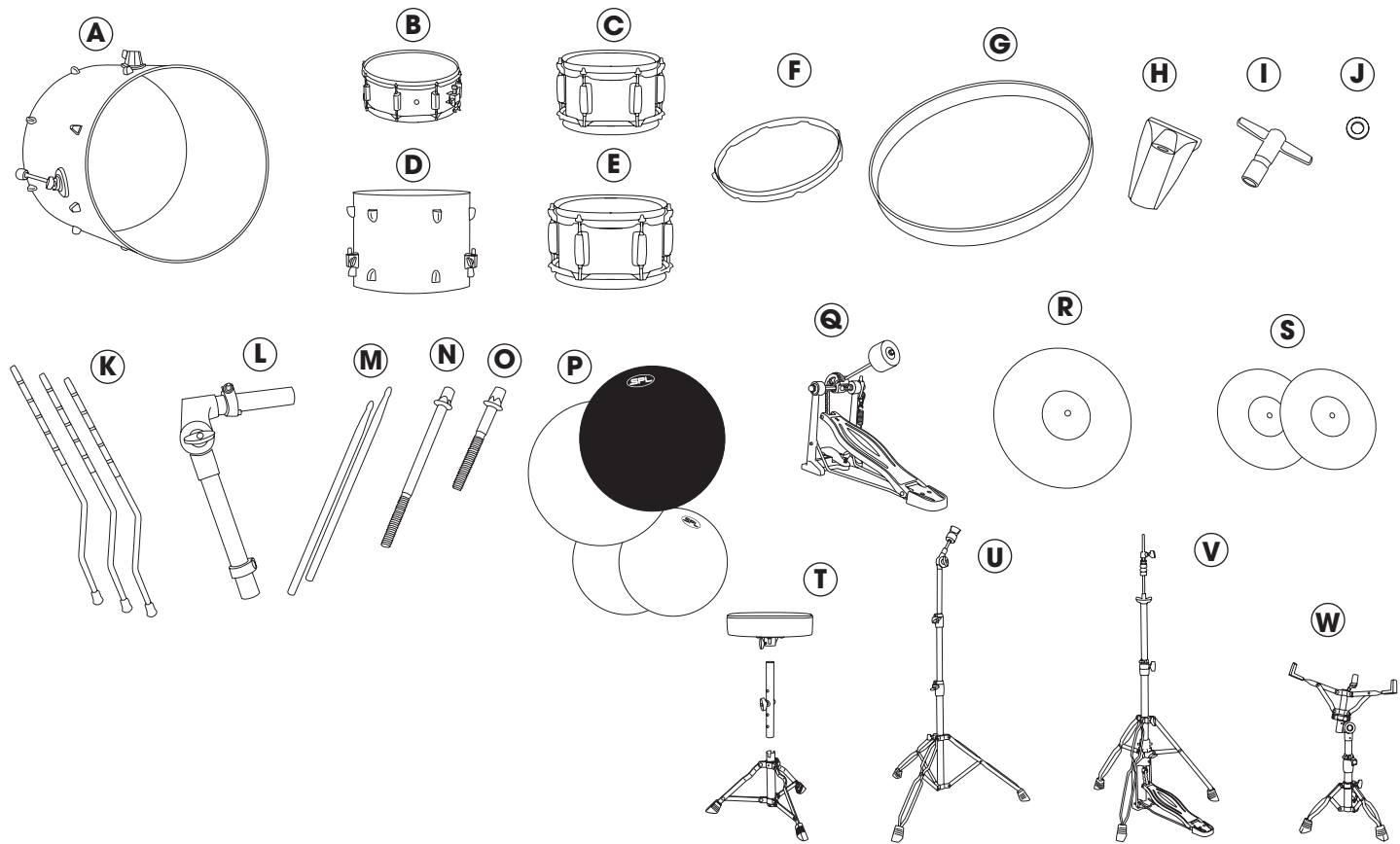

### SET INCLUDES:

- A** 22 x 16" Bass Drum Shell
- B** 14 x 5" Snare Drum (assembled)
- C** 10 x 8" Tom (assembled)
- D** 16 x 14" Floor Tom Shell
- E** 12 x 9" Tom (assembled)
- F** Two 16" Tom Hoops
- G** Two Bass Drum Hoops
- H** 16 Bass Drum Claw Hooks
- I** Drum Key
- J** Washers
- K** Three Floor Tom Legs
- L** Two Tom Arms
- M** Pair of Drumsticks
- N** 16 Long Tension Rods for Bass Tom
- O** 16 Short Tension Rods for Floor Tom

### **P** D4522 Drum Heads:

- 22" Clear Bass Drum Head (Batter Side)
- 22" Black Resonant Bass Drum Head (Front Side)
- 16" Clear Head (Batter Side)
- 16" Clear Head (Resonant Side)

### Hardware:

- Q** Bass Drum Pedal
- R** 18" Cymbal
- S** Pair of 14" Hi-Hat Cymbals
- T** Drum Throne
- U** Cymbal Stand
- V** Hi-Hat Stand
- W** Snare Drum Stand

*D4522 5-Piece Complete Unity Kit	Hardware, Cymbals, Drum Throne	Included
*D4420 4-Piece Shell Pack Plus Unity Kit	Cymbals, Drum Throne	Sold Separately

# Assembly Instructions: D4420, D4522

## Bass Drum Head Assembly

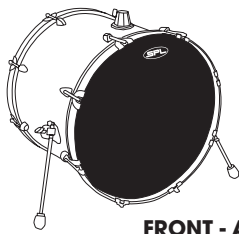

FRONT - Audience Side

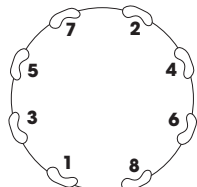

**1.** Place black bass drum head with the SPL logo on front of the bass drum shell.

**2.** Place bass drum hoop onto drum head.

**3.** Insert long tension rod / washer / bass drum claw hook assembly into bass drum lug. Make sure claw hook is secure on the bass drum hoop. Tighten with your fingers.

**4.** Repeat this for all the lugs on one side of the drum.

**5.** After all tension rods on one side are finger tight, use the drum key to tighten the #1 tension rod 3 turns. Follow these steps for tension rods #2 through #8 in a criss-cross pattern as shown. Repeat this pattern, tightening each rod one half turn until the drum head is taut and wrinkle free.

**6.** Repeat for the clear batter head on the opposite side of the drum.

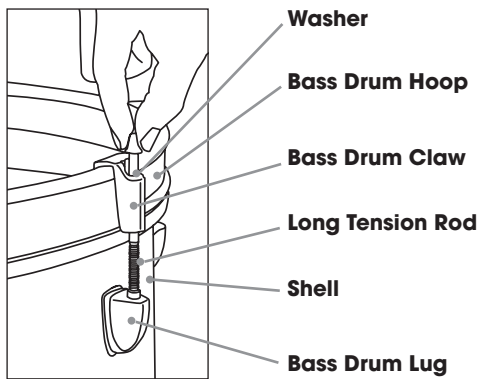

## Bass Drum Leg Assembly (Spurs)

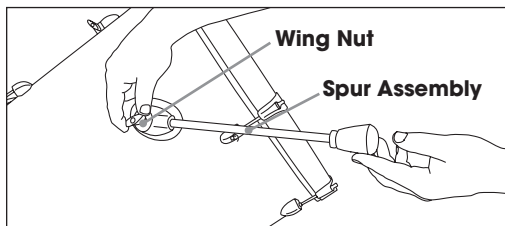

**1.** Loosen wing nut on spur assembly.

**2.** Rotate the bass drum spur down and forward.

**3.** Tighten the bass drum spur into the forward position.

## Tom and Floor Tom Head Assembly

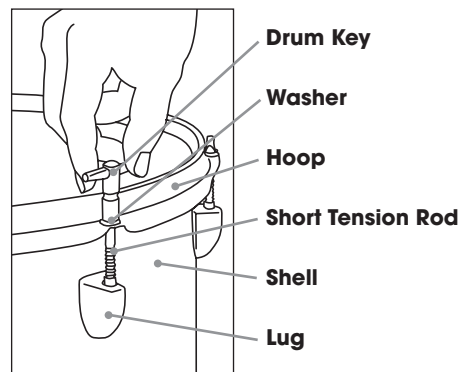

**1.** Place drum head on top of the drum shell.

**2.** Place the metal hoop over the drum head, aligning the holes in the hoop with the drum lugs.

**3.** Insert short tension rods with metal washers through the holes in the hoop.

**4.** Thread the tension rods into the lugs and finger tighten.

**5.** Using the drum key, gradually tighten each tension rod in equal amounts using the same criss-cross pattern as done on the bass drum until the head is taut and wrinkle free.

**6.** Repeat above steps for the bottom of the drum with the resonant side drum head.



## Floor Tom Leg Assembly

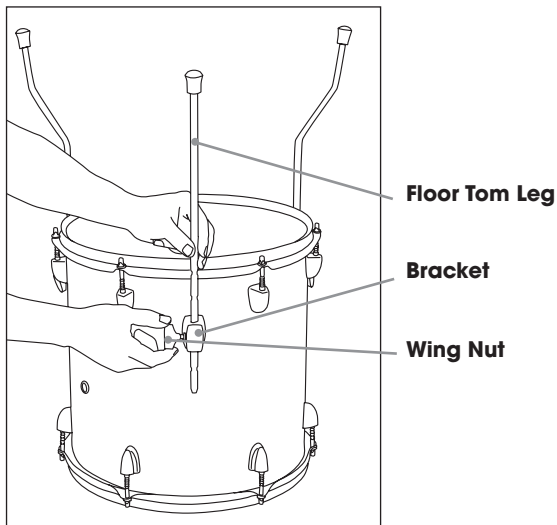

1. Insert floor tom leg into the bracket.
2. Tighten the wing nut on the bracket.
3. Repeat for remaining legs.
4. Adjust height of legs for comfortable playing style.

## Mounting the Toms to the Bass Drum

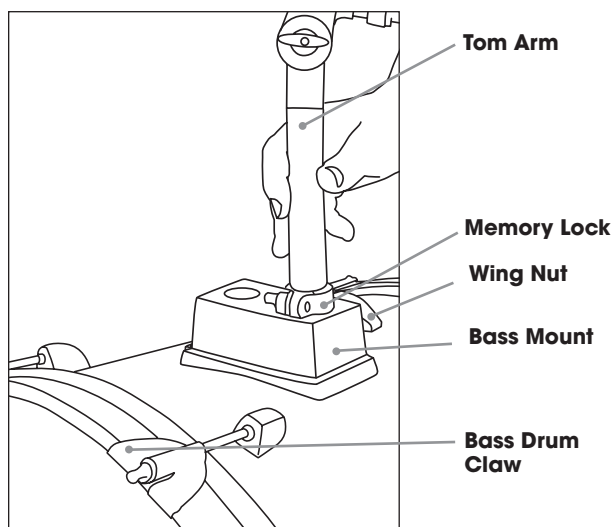

1. Insert long section of the first tom arm a few inches into the bass mount. Wing nut faces left when standing behind base drum.
2. Tighten the wing nut on the bass mount.
3. Loosen the wing nut on the tom arm and position the top part of the tom arm to just below horizontal and retighten the wing nut.
4. Place the mounted tom onto the tom arm and tighten the wing nut on the tom mount.
5. Repeat for the second tom (D4522).
6. Adjust height and angle of toms for comfortable playing style.

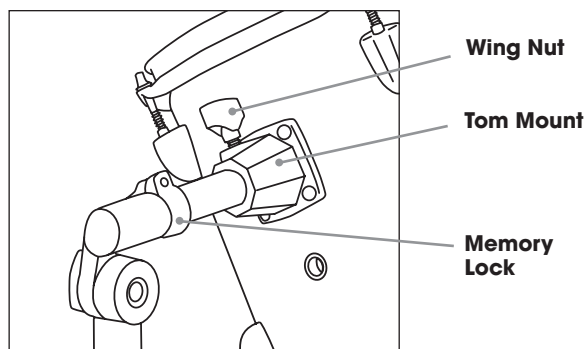

7. Secure memory locks for additional stability and memory by tightening the collar of the memory lock to the mounts of the bass and tom. The next time you need to set up the drums, the memory locks will ensure the same angle and height.

# Hardware: D4420, D4522

## Cymbal Stand Assembly

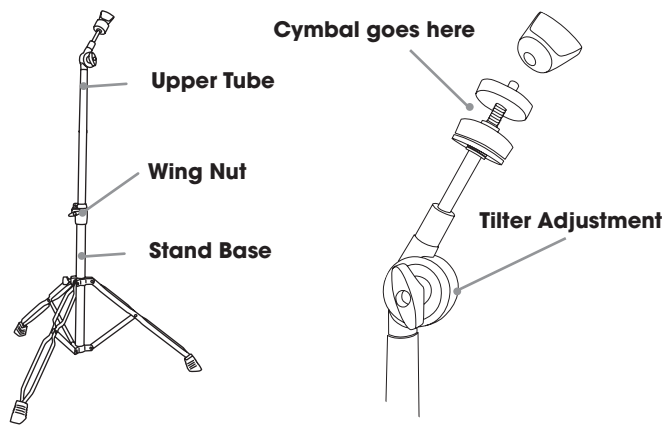

1. Extend legs to open position. Tighten wing nut.
2. Slide upper tube into stand base and set desired height by tightening wing nuts.
3. Place cymbal (D4420 cymbals sold separately) between felt pads. Tighten wing nut above cymbal only enough to hold cymbal and felts, but loose enough to let cymbal move freely when struck.
4. Set desired cymbal angle using tilter adjustment.

## Snare Drum Stand Assembly

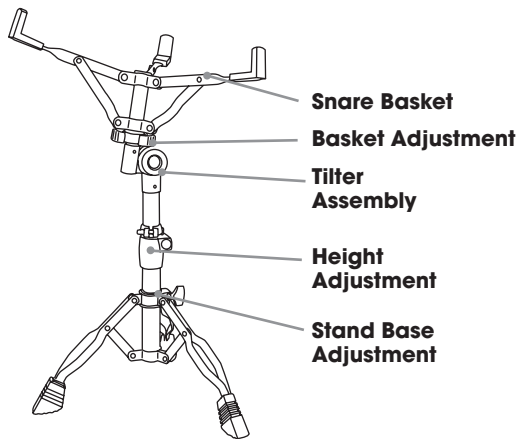

1. Extend legs to open position and tighten wingnut.
2. Insert snare basket into stand base and tighten the wing nut at the desired height.
3. Adjust the basket to the desired angle with the tilter assembly.
4. Place drum in snare basket. The basket can be adjusted to grip and fit the drum.

## Attaching the Bass Drum Pedal

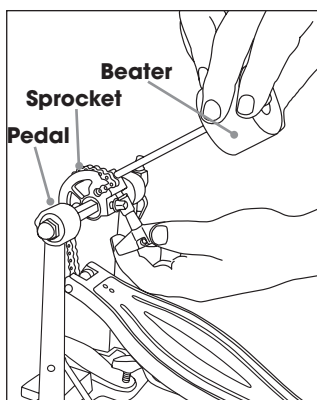

1. Insert the felt beater into the bass drum pedal sprocket and tighten with the drum key.

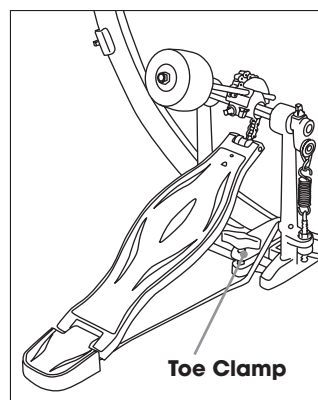

2. Attach bass pedal to the bass drum hoop via the toe clamp.

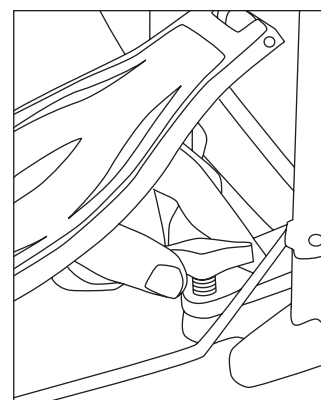

3. Tighten the wing nut on the toe clamp until secure.



## Hi-Hat Cymbal Stand Assembly

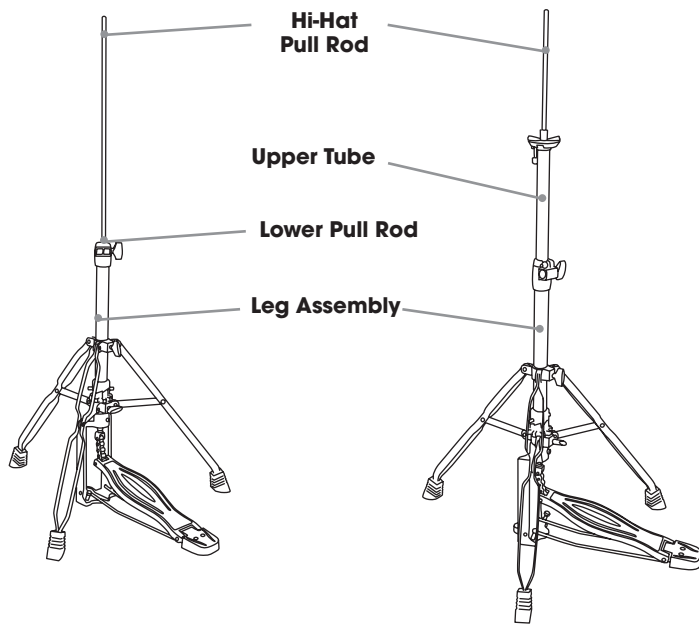

1. Thread hi-hat pull rod into lower pull rod leg assembly.
2. Slide upper tube over the hi-hat rod and into leg assembly. Tighten the wing nut at desired height.
3. Place one hi-hat cymbal onto the hi-hat rod with the bottom side of the cymbal facing up.
4. Remove lower retaining nut and one rubber washer from hi-hat clutch. Place the hi-hat clutch into the top of the second hi-hat cymbal, and reassemble the rubber washer and retaining nut under the cymbal. The cymbal should rest between the two rubber washers.
5. Place the hi-hat clutch assembly and cymbal onto the hi-hat rod. Tighten the wing nut on the hi-hat clutch with the top cymbal approximately one to two inches above the lower cymbal. Depressing the hi-hat pedal will engage the two cymbals.

### Close Up Of Hi-Hat Clutch Assembly\*

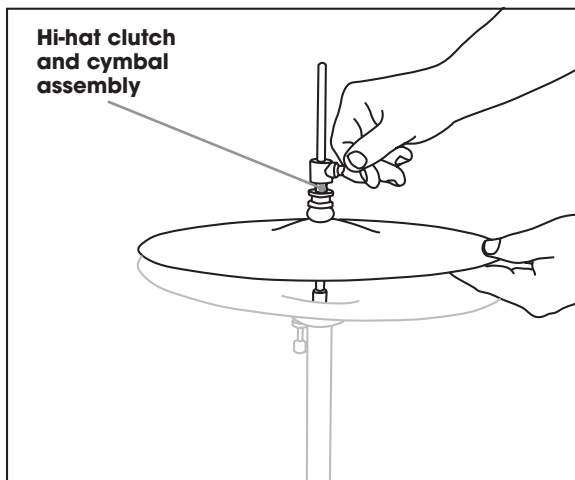

\*D4420 cymbals sold separately.

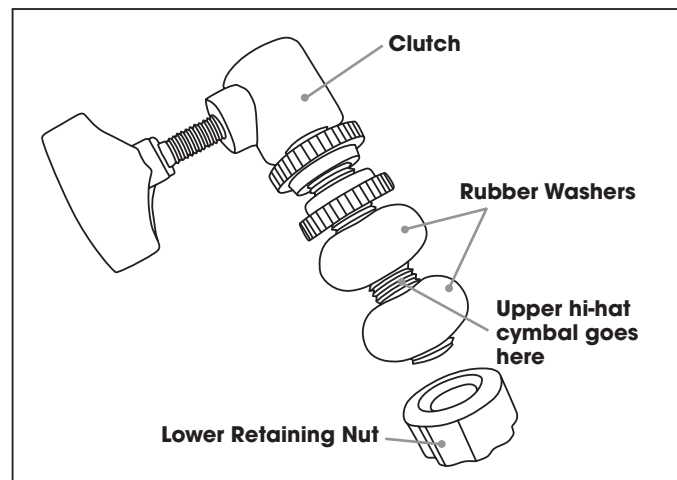



## Assembling the Drum Throne

---

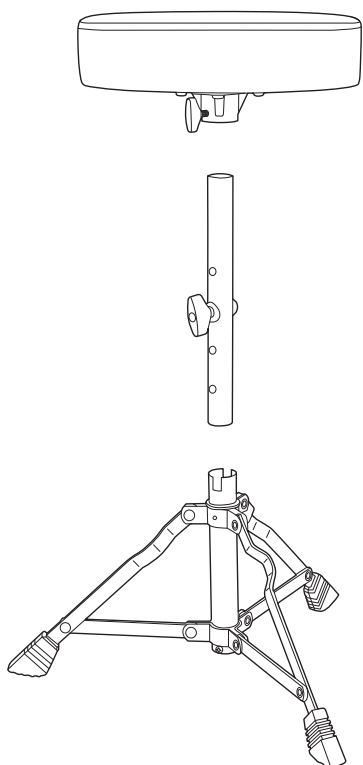

1. Fold out legs of base.
  2. Place upper tube into base and tighten height adjustment wing nut. Use the second hole position as shown for comfortable playing style.
  3. Place seat top and tighten wingnut.
- \*D4420 drum throne sold separately.

## Top View of Drum Placement: D4420

---

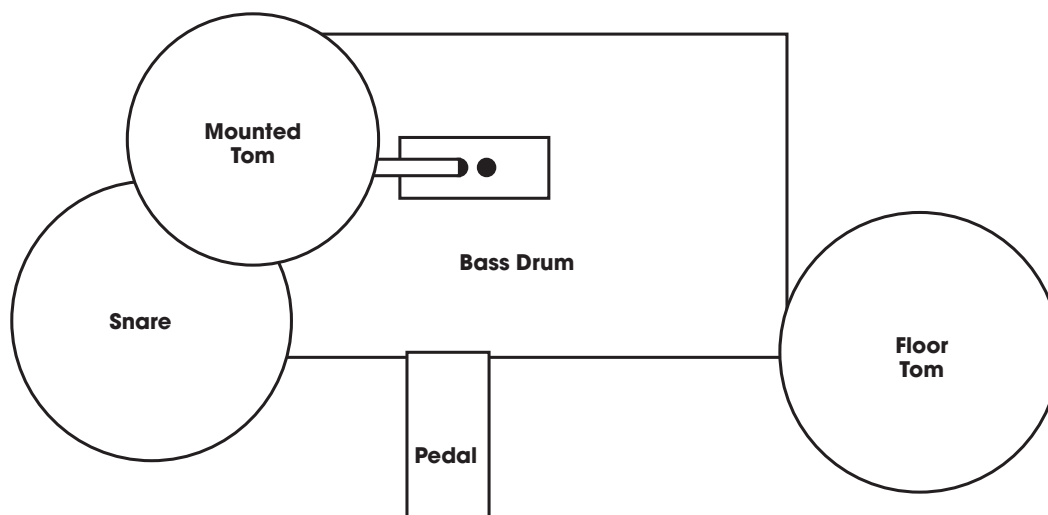

**Top View of  
Drum Placement: D4522**

---

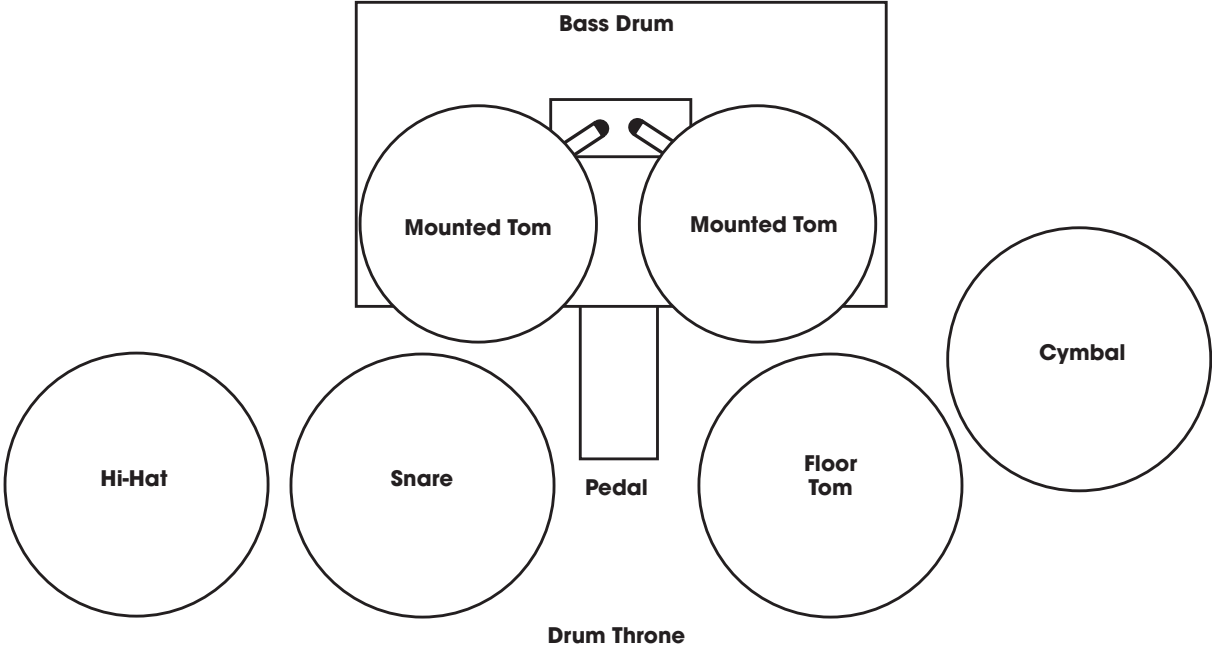

One (1) Year Limited Warranty

Subject to the limitations set forth below, Sound Percussion Labs™ hereby represents and warrants that the components of this product shall be free from defects in workmanship and materials, including implied warranties of merchantability or fitness for a particular purpose, subject to normal use and service, for one (1) years to the original owner from the date of purchase.

Limits of Liability

Retailer and manufacturer shall not be liable for damages based upon inconvenience, loss of use of product, loss of time, interrupted operation or commercial loss or any other incidental or consequential damages including but not limited to lost profits, downtime, goodwill, damage to or replacement of equipment and property, and any costs of recovering, reprogramming, or reproducing any program or data stored in equipment that is used with Sound Percussion Labs™ products. This guarantee gives you specific legal rights. You may have other legal rights which vary from state to state. Some states do not allow limitations on how long an implied warranty lasts, so the above limitation may not apply to you.

Sound Percussion Labs  
P.O. Box 5111  
Thousand Oaks, CA 91359-5111

All trademarks and registered trademarks mentioned herein are recognized as the property of their respective holders.

1406-10186





[SoundPercussionLabs.com](http://SoundPercussionLabs.com)